

# SLIDE VALVES, Series VCS

## SLIDE VALVES

The 3/2 slide valve is normally used as a circuit on-off valve. When the ring nut is moved back, the system downstream is relieved; when the ring nut is moved forward, the system is supplied with compressed air.



## TECHNICAL DATA

|   | 1/8"                                    | 1/4" | 3/8" | 1/2" |      |
|---|---|------|------|------|------|
| Operating pressure                                  | 0 ÷ 10 bar (0 ÷ 1 MPa)                  |      |      |      |      |
| Operating temperature range                         | -10 ÷ 80°C                              |      |      |      |      |
| Fluid   | Lubricated or unlubricated filtered air |      |      |      |      |
| Flow rate at 6.3 bar (0.63 Mpa ÷ 91 psi) ΔP 0.5 bar | NI/min                                  | 430  | 680  | 1400 | 2200 |
| Flow rate at 6.3 bar (0.63 Mpa ÷ 91 psi) ΔP 1 bar   | NI/min                                  | 630  | 1040 | 2070 | 3330 |
| Conductance C                                       | [NI/min · bar]                          | 170  | 247  | 537  | 833  |
| Critical ratio b                                    | bar/bar                                 | 0.2  | 0.3  | 0.1  | 0.2  |

## COMPONENTS

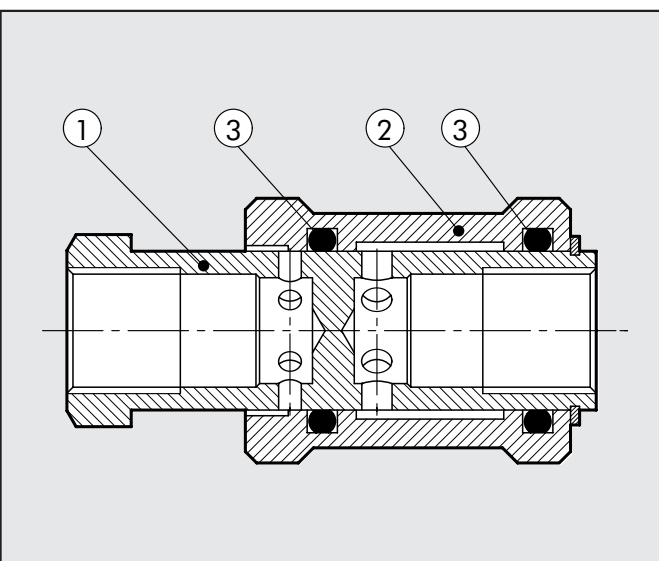

- ① Body: chromium-plated brass
- ② Ring nut: anodized aluminium
- ③ Seals: NBR

## DIMENSIONS AND ORDERING CODES

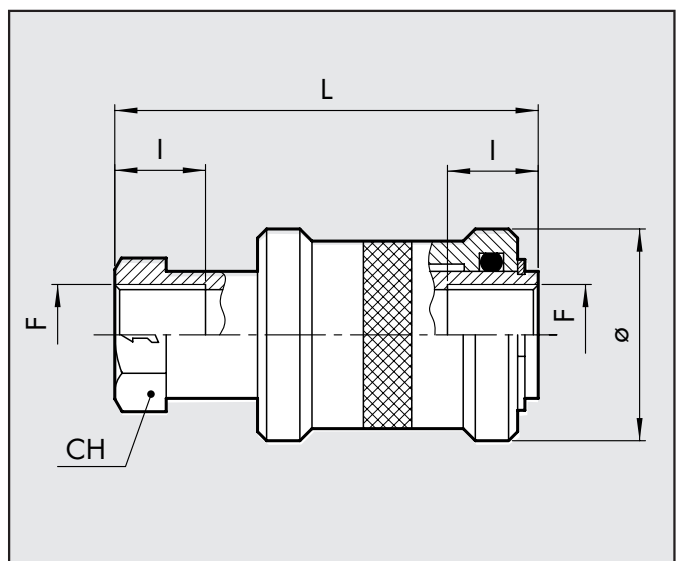

| Code        | Description      | F    | ∅  | I  | L  | CH |
|-------------|------------------|------|----|----|----|----|
| W0970050001 | SLIDE VALVES 3/2 | 1/8" | 25 | 10 | 48 | 11 |
| W0970050002 | SLIDE VALVES 3/2 | 1/4" | 30 | 12 | 58 | 19 |
| W0970050003 | SLIDE VALVES 3/2 | 3/8" | 35 | 12 | 68 | 22 |
| W0970050004 | SLIDE VALVES 3/2 | 1/2" | 40 | 15 | 80 | 27 |