

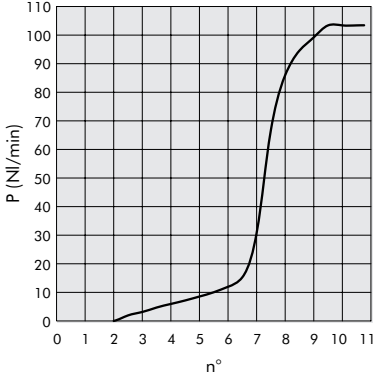

### FLOW CHARTS

#### MRF M5

FLOW RATE FOR Ø5 PIPE



#### MRF 1/8"

FLOW RATE FOR Ø6 PIPE

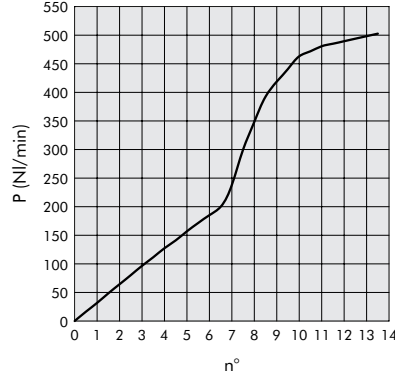

#### MRF 1/4"

FLOW RATE FOR Ø8 PIPE

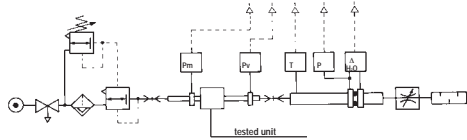
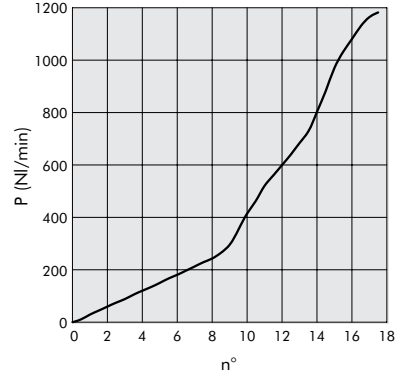

• Flow rate tests carried out by the Department of Mechanics at the Turin Polytechnic using a computerized test station and in compliance with CETOP RP50R recommendations (approved by ISO DIS 6358-2) with ISO 5167 diaphragm gauge.

#### OVERALL DIMENSIONS: MRF "R" RING

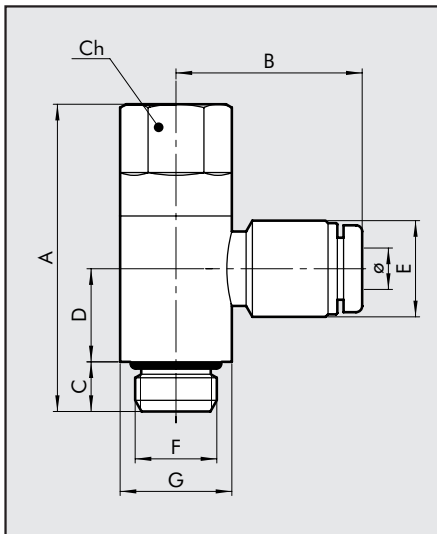

	F	Ø	A	B	C	D	E	G	CH
M5	4	4	28	24	5	5.5	10	10	9
1/8"	4	4	37	25	7	11.5	11	14	12
M5	5	5	28	25	5	5.5	11	10	9
1/8"	5	5	37	25	7	11.5	12	14	12
1/8"	6	6	37	26	7	11.5	13	14	12
1/4"	6	6	50	28	9	15	13	18	16
1/8"	8	8	37	31	7	11.5	15	14	12
1/4"	8	8	50	31	9	15	15	18	16
1/4"	10	10	50	36	9	15	18	18	16

#### OVERALL DIMENSIONS: THREADED RING

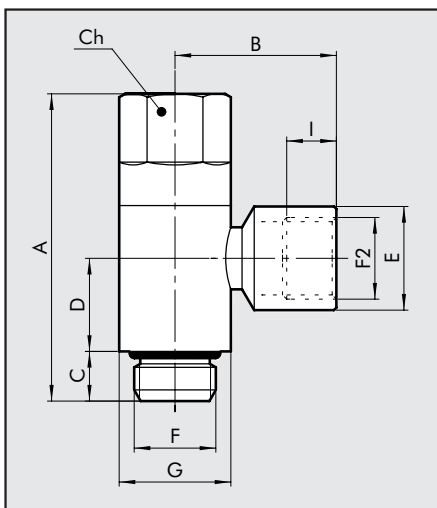

	F	F2	A	B	C	D	E	G	I	CH
1/8"	1/8	1/8	37	20.5	7	11.5	13.5	14	7	12
1/4"	1/4	1/4	50	24.5	9	15	17	18	8	16



## ORDERING CODES

### UNIDIRECTIONAL CYLINDER VERSION WITH PUSH-IN FITTING

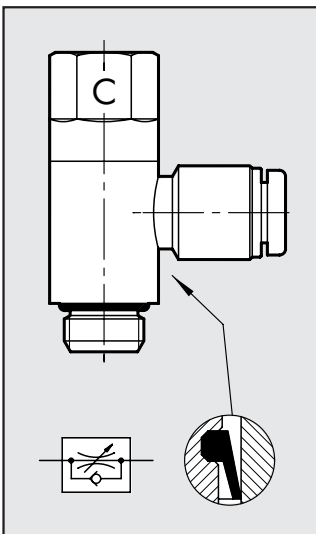

Code	Ref.
9001001	MRFO C 4 M5
9001011	MRFO C 4 1/8
9001002	MRFO C 5 M5
9001012	MRFO C 5 1/8
9001003	MRFO C 6 1/8
9001004	MRFO C 6 1/4
9001005	MRFO C 8 1/8
9001006	MRFO C 8 1/4
9001008	MRFO C 10 1/4

### UNIDIRECTIONAL CYLINDER VERSION WITH FEMALE PORT

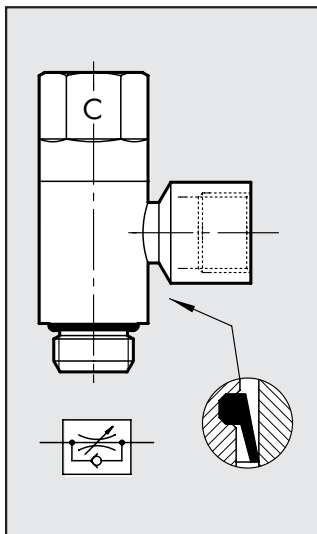

Code	Ref.
9001020	MRFO CF 1/8 - 1/8
9001021	MRFO CF 1/4 - 1/4

### UNIDIRECTIONAL VALVE VERSION WITH PUSH-IN FITTING

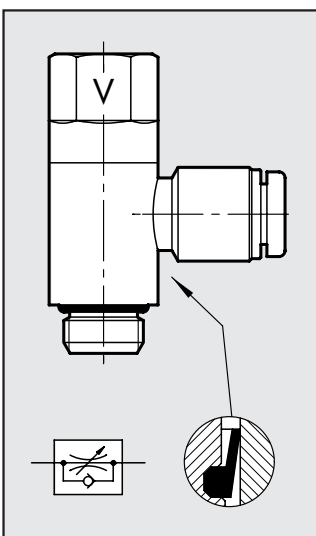

Code	Ref.
9001111	MRFO V 4 1/8
9001112	MRFO V 5 1/8
9001101	MRFO V 6 1/8
9001102	MRFO V 6 1/4
9001103	MRFO V 8 1/8
9001104	MRFO V 8 1/4
9001106	MRFO V 10 1/4

### UNIDIRECTIONAL VALVE VERSION WITH FEMALE PORT

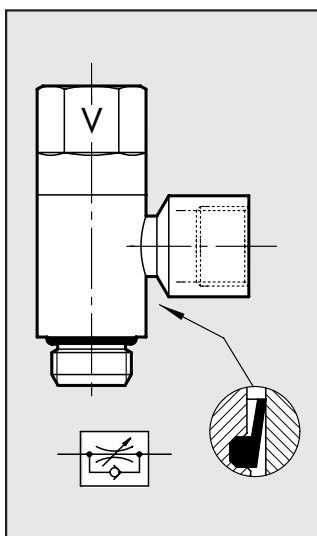

Code	Ref.
9001120	MRFO VF 1/8 - 1/8
9001121	MRFO VF 1/4 - 1/4

### BIDIRECTIONAL VERSION WITH PUSH-IN FITTING

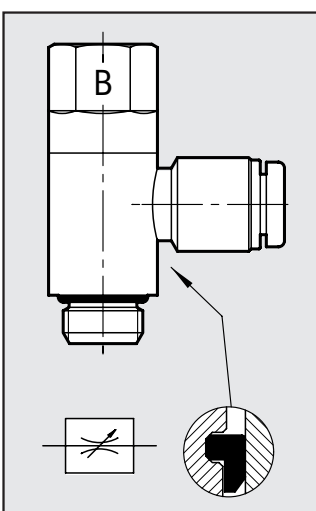

Code	Ref.
9001601	MRFO B 4 M5
9001602	MRFO B 4 1/8
9001603	MRFO B 5 M5
9001604	MRFO B 5 1/8
9001605	MRFO B 6 1/8
9001606	MRFO B 6 1/4
9001607	MRFO B 8 1/8
9001608	MRFO B 8 1/4
9001609	MRFO B 10 1/4

### BIDIRECTIONAL VERSION WITH FEMALE PORT

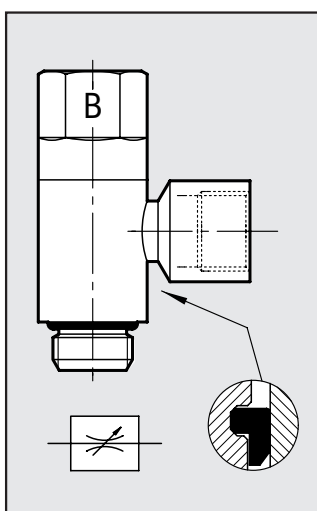

Code	Ref.
9001620	MRFO BF 1/8 - 1/8
9001621	MRFO BF 1/4 - 1/4